



OTRT Track Specifications

ALL INCLUSIVE

1.1 CUBICLE TRACK

A. TRACK SAMPLES

1. **TRACKMATERIAL:** Track made of extruded aluminum with white baked enamel finish. All bends shall be 12" radius up to 90 degrees.
2. **LIST OF PARTS:** (Part Number, Description and image below)

OTRTA02 – Track Adapter

(Image below not exact representation but similar)

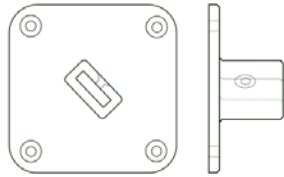

OTRTB02 – Hard Ceiling Mounting Plate

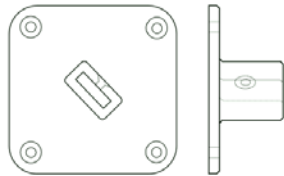

OTRTC02 - End Wall Plate

(where applicable when track touches perpendicular wall)

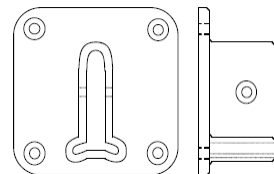

OTRTC02SE – Swivel End Wall Plate

(where applicable when track touches wall at any angle not 90 degrees)

(Image below not exact representation but similar)

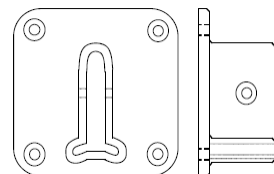



OTRT Track Specifications ALL INCLUSIVE

2. LIST OF PARTS: (Continued)

OTRTDo2 – Hangar and Tube Connector

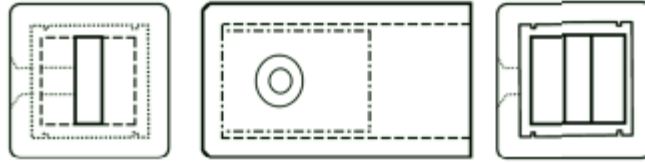

OTRTEo2 - Hanger&track Connector

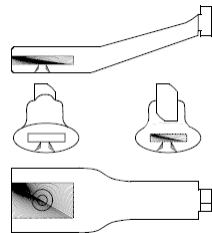

OTRTFo2 - Track Connector

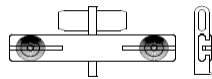

OTRTGo2– Hanger

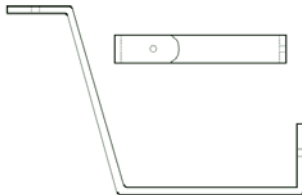

OTRTH3o2 - 180° 3F Track



OTRTH4o2 - 180° 4F Track



OTRTH5o2 - 180° 5F Track



OTRTH8o2 - 180° 8F Track





OTRT Track Specifications ALL INCLUSIVE

2. LIST OF PARTS: (Continued)

OTRTJo2 – Extensible Square Tube



OTRTK102 - 90° 1F Radius Track

OTRTK1R02 - 90° 1F Reverse Radius Track

OTRTL102 - 135° 1 F Radius Track

OTRTL1R02 - 135° 1F Reverse Radius Track

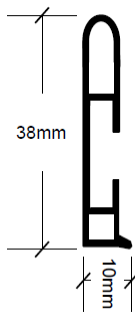

OTRTMo2 - End Cap

(where applicable when track does not intersect with a wall)

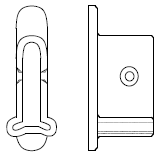

OTRTPo2 – Ceiling Tube Mounting Plate

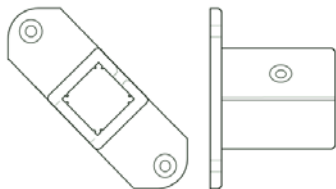



OTRT Track Specifications ALL INCLUSIVE

2. LIST OF PARTS: (Continued)

OTRTQ02 – Room Divider Wall Mount

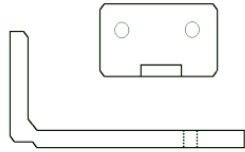

OTRTS02 - Swivel Clip

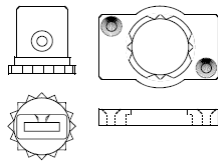

OTRTT02 – Trial Track Adapter

(Image below not exact representation but similar)

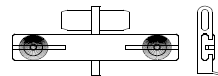

OTRTS102 - 5/32"x8mm set screw
(For OTRTB02, OTRTE02, OTRTF02)



OTRTS302 - 5/32"x13mm self tap screw
(For OTRTC02, OTRTM02, OTRTP02)



OTRTS402 - 5/32"x1-1/4" mount screw
(For OTRTB02, OTRTC02, OTRTP02)



OTRTS602 - 5/32"x13mm set screw
(For OTRTD02, OTRTT02)



OTRTS702 - 5/32"x3" screw





OTRT Track Specifications ALL INCLUSIVE

2. LIST OF PARTS: *(Continued)*

OTRTS802- Plastic anchor for OTRTS402
(For OTRTS402, in drywall/wood/concrete at walls & ceilings)



OTRTS902 - 5/32"x3/4" self tap screw
(For OTRTC02, OTRTM02, OTRTP02)



3. OVERALL REPRESENTATIONS:

A. Hard Ceiling Illustration





OTRT Track Specifications ALL INCLUSIVE

B. RETROFIT Illustration



Detail of Suspending the OTRT track into an existing track.
100% Aluminum, comes in 2foot lengths, field cut to desired length



OTRT Track Specifications ALL INCLUSIVE

C. HARD CEILING/SUSPENDEd GRID COMBO Illustration





OTRT Track Specifications ALL INCLUSIVE

D. INSTALLATION INSTRUCTIONS

a. 15/16" SUSPENDED GRID INSTALLATION INSTRUCTIONS

Special Installation Instructions

15/16th Drop Ceiling Grid Mount

The "Drop Ceiling Grid Mount" is a two piece mount. The center of the mount can be positioned and locked in place prior to attaching to drop ceiling grid work.

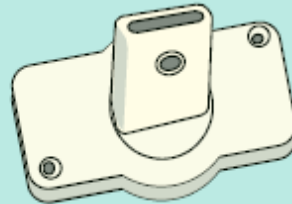

The center of the mount can be placed in one of 8 positions to accommodate installation needs.

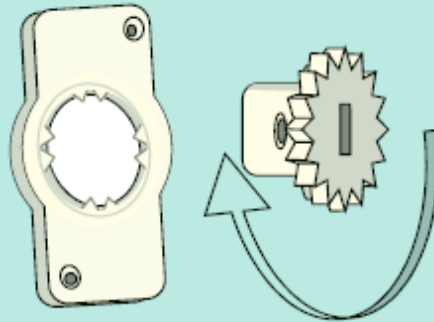

Swivel Clips should be secured 24" apart. This also allows the grabber enough space to remove and replace curtains. Please remember that if the track is secured with a wall plate then a ceiling support is not needed.

15/16th Drop ceiling grid.

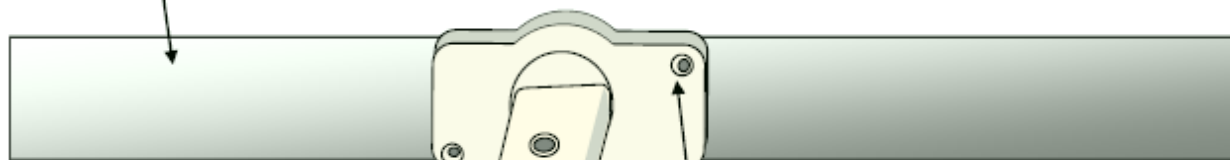

Use the OPTS S902 screws to attach to ceiling grid.





b. RECESSED SUSPENDED GRID INSTALLATION INSTRUCTIONS

Special Installation Instructions

Drop Ceiling Grid Mount with **RECESSED** tiles.

In some cases, it may be necessary to use spacers under the each swivel clip due to the use of recessed tiles.

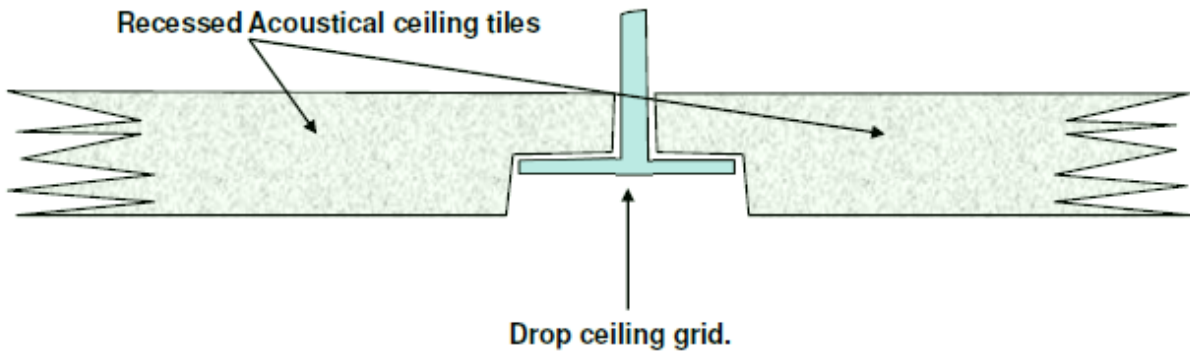

Nylon spacers are available at most home improvement stores.

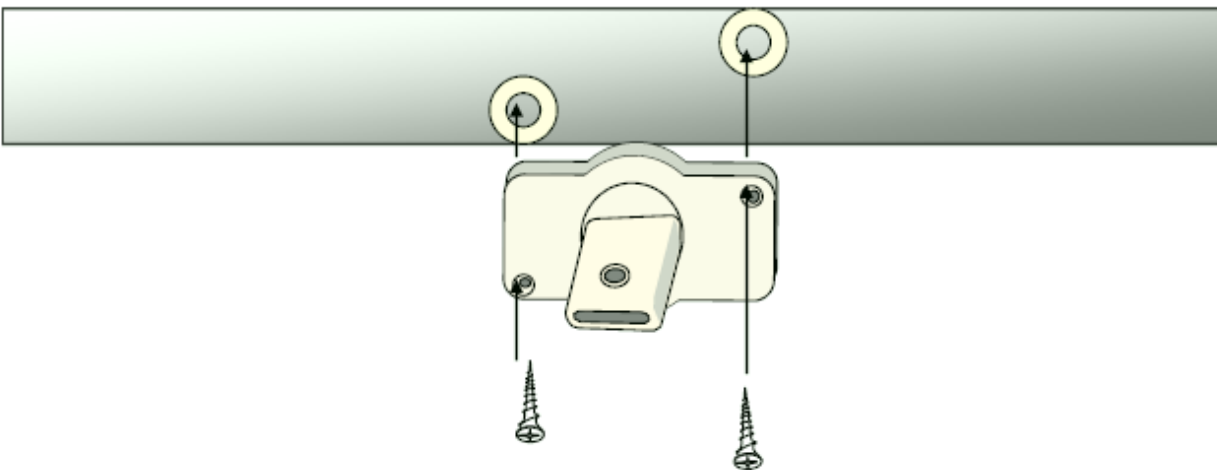

Using white nylon spacers will allow the swivel clip to be installed without interfering with the recessed acoustic tiles.



c. 9/16" SUSPENDED GRID INSTALLATION INSTRUCTIONS

Special Installation Instructions

9/16th Inch Drop Ceiling Grid Mount

To install into the smaller 9/16th drop ceiling grid, be sure to line up the hanger slot with the screw holes of the swivel clip.

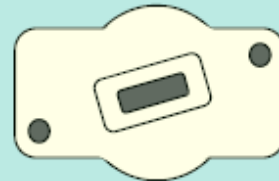

If the ceiling tiles are recessed, spacers will need to be used. Please refer to page 7.

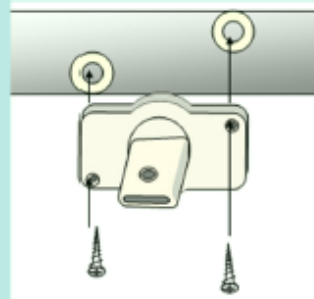

Swivel Clips should be secured 24" apart. This also allows the grabber enough space to remove and replace curtains. Please remember that if the track is secured with a wall plate then a ceiling support is not needed.

9/16th Drop ceiling grid.

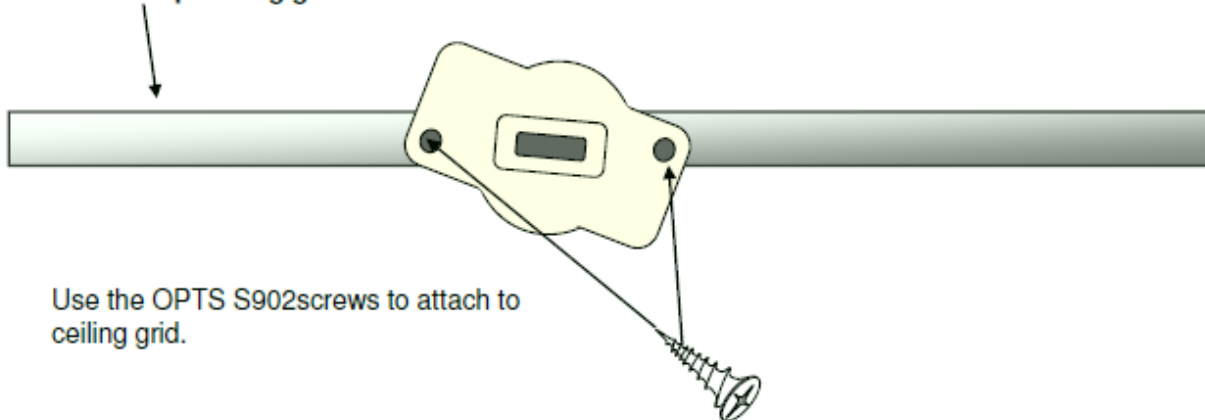

Use the OPTS S902 screws to attach to ceiling grid.



OTRT Track Specifications
ALL INCLUSIVE

d. HARD CEILING INSTALLATION INSTRUCTIONS

Special Installation Instructions

Hard Ceiling Installation

After determining location for hard ceiling mount plate, pre-drill 3/8" holes to accommodate plastic anchors. Insert anchors and secure with OPTS-S402 5/32"x1-1/4" mount screws

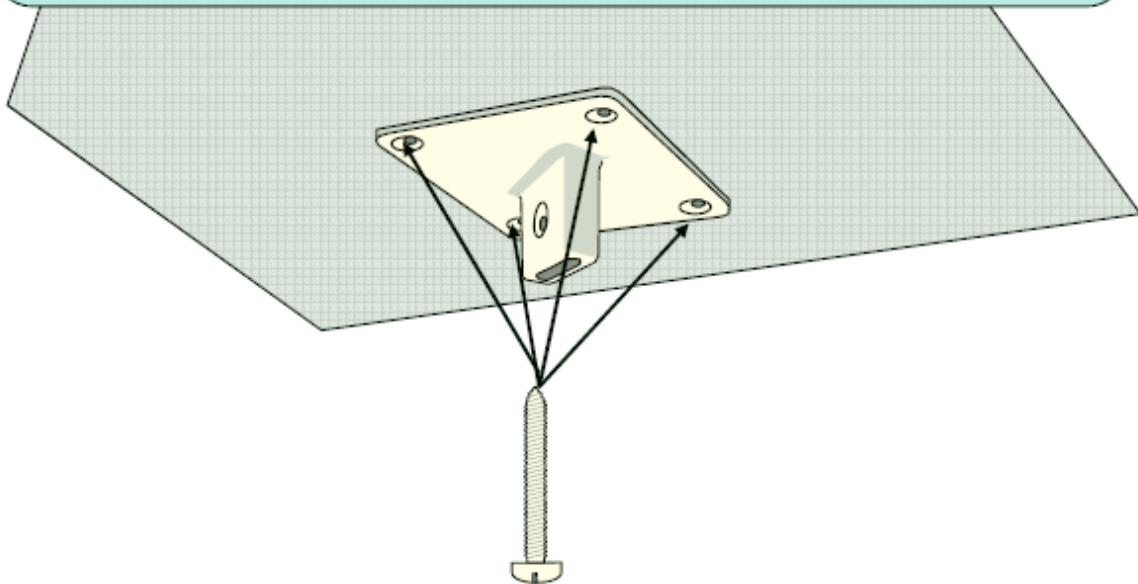

A laser level is very useful when laying out locations for the hard ceiling mount plates.



e. HARD CEILING WALL MOUNT INSTALLATION INSTRUCTIONS

Special Installation Instructions

Hard Ceiling Installation

After determining location for wall mounts, pre-drill 3/8" holes to accommodate plastic anchors. Insert anchors and secure with OPTS-S402 5/32"x1-1/4" mount screws

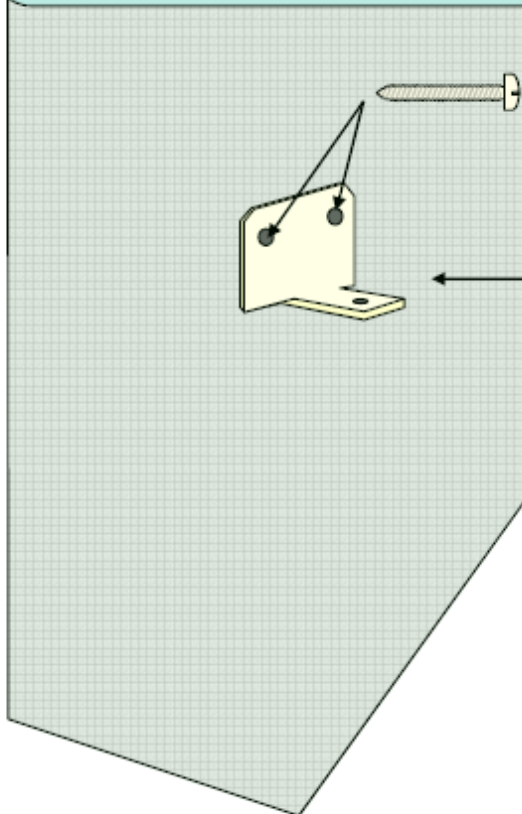

After the track and hanger connector has been inserted into the back of the track, slide onto the wall mount and secure with a OPTS-S102 set screw..

A laser level is very useful when laying out locations for the wall mount plates.



OTRT Track Specifications
ALL INCLUSIVE

f. SUSPENDED INSTALLATION INSTRUCTIONS

Installation Instructions

Extensible Tubes

To connect **Extensible Tube** to the **Ceiling Vertical Mount Plate**, you may need a rubber mallet to completely insert the tube. **Do this before you attach the mount plate to the ceiling.** The mount plate is designed to taper so that once the tube has been completely inserted it will not flex. Be sure to insert cut end or end that **does not** have the manufactured hole.

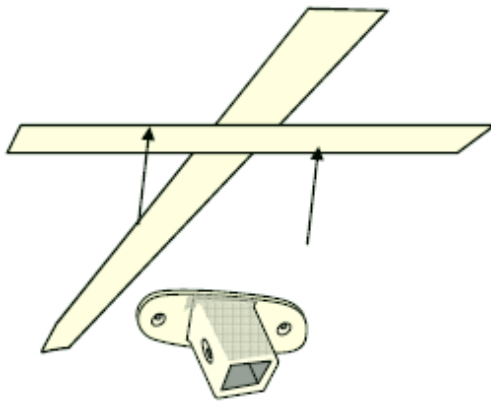

Insert **Hanger** into **Tube/Hanger Connector** and secure with long set screw.

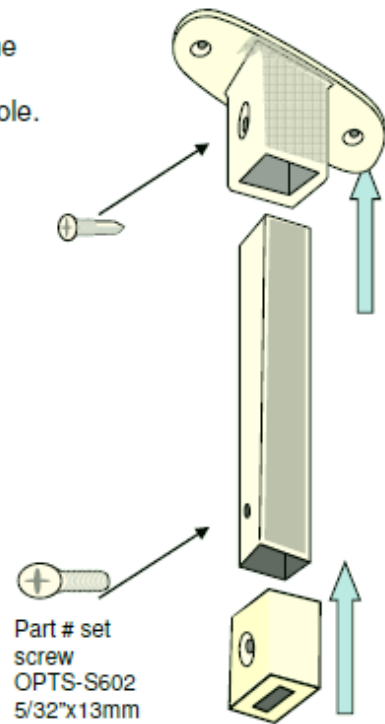

Special Note: Extensible tubes can be used to drop the rail up to 18".

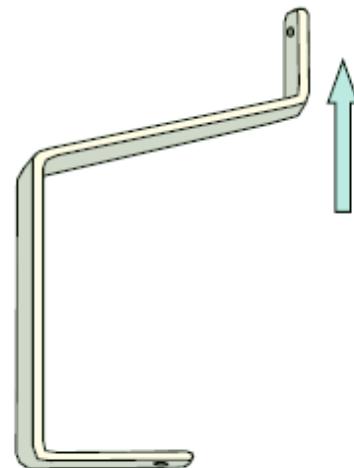



OTRT Track Specifications ALL INCLUSIVE

g. RETROFIT INSTALLATION INSTRUCTIONS

Installation Instructions

“Retro Fit” Into Existing Rail

The Swivel clip can be installed directly into the existing track using the T02 track Adapter. This track adapter is designed to fit in most rail. In some cases very thin rail will not work with the track adapter

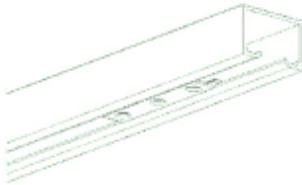

1. To insert the track adapter (T02) into the track



2. To insert the S702 screw from the middle of Swivel (S02)

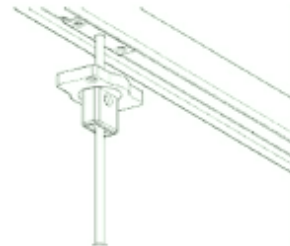

3. To connect S02 and T02 by insert S702 screw into the center screw hole of T02 . to fix the position of T02 on the track.

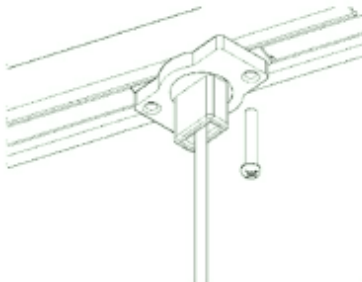

4. To connect S02 and T02 by insert 2 pieces S602

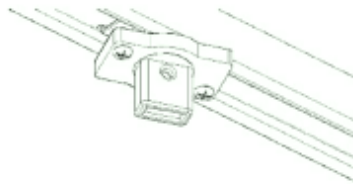

5. Take off the S702 screw



OTRT Track Specifications ALL INCLUSIVE

h. ASSEMBLY INSTRUCTIONS

Installation Instructions

PARTS ASSEMBLY

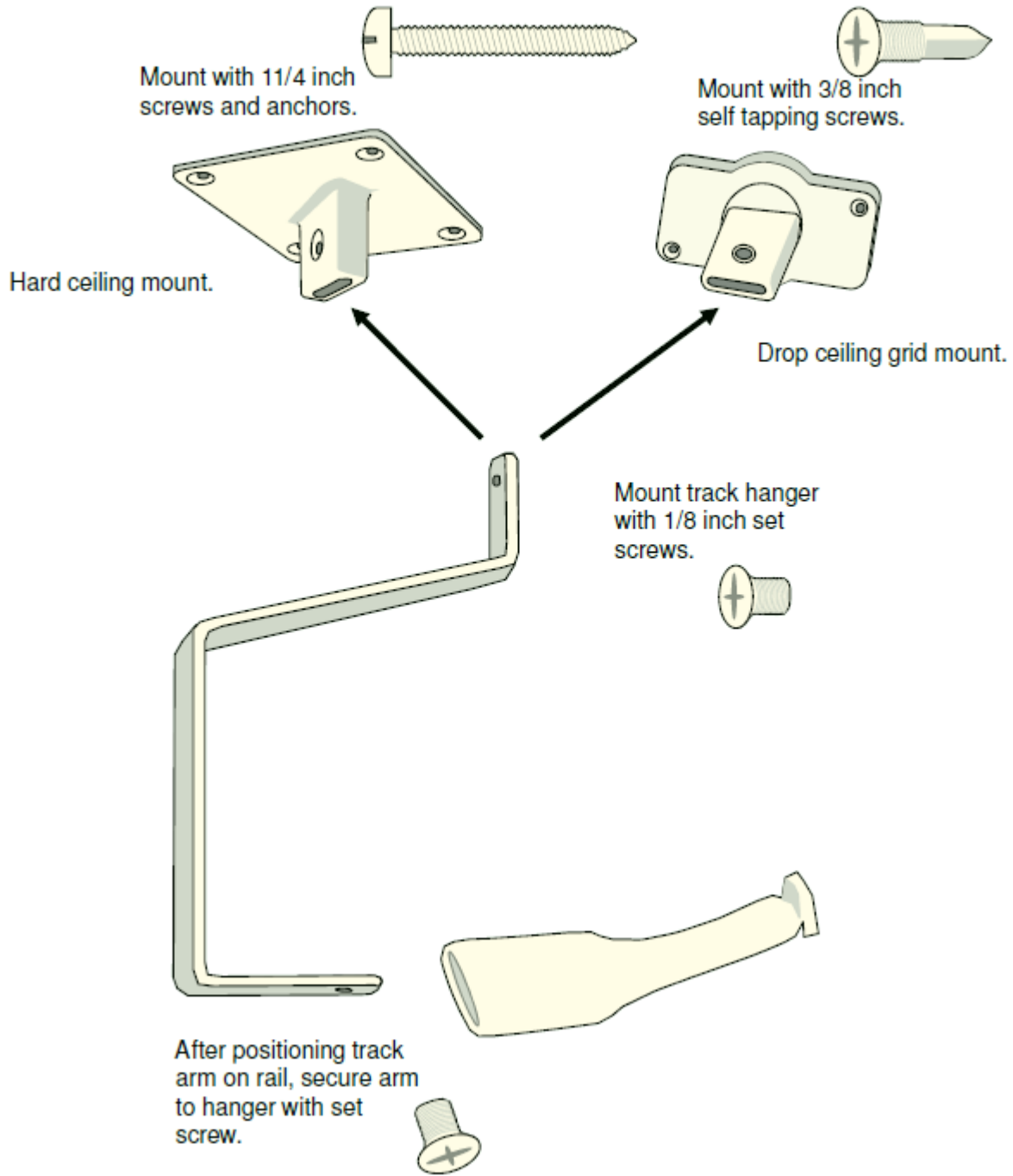



OTRT Track Specifications ALL INCLUSIVE

h. ASSEMBLY INSTRUCTIONS (Continued)

Installation Instructions

PARTS ASSEMBLY

Join track pieces by sliding the **Track Connector** into each adjoining end of track.

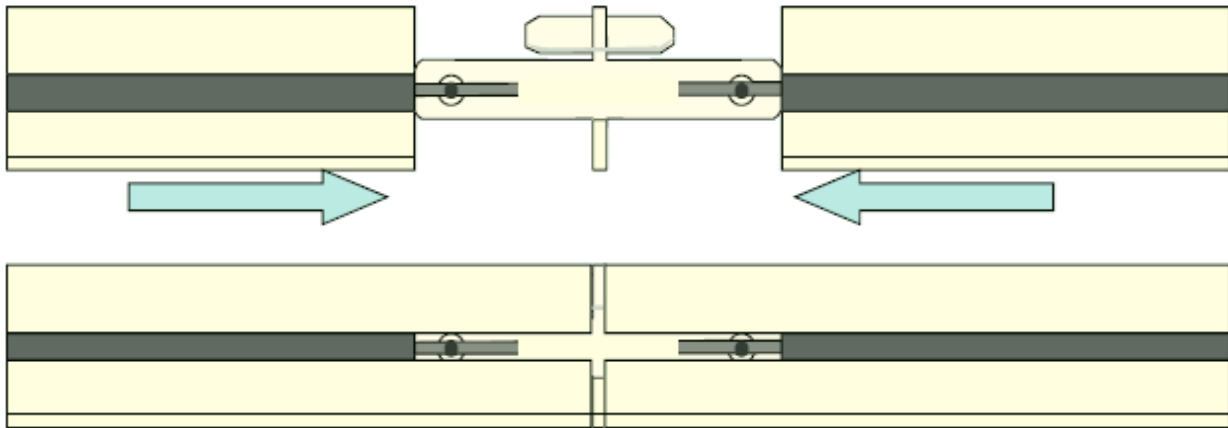

Once the **Track Connector** is in place, secure with **Set Screws**.

SPECIAL NOTE: During the installation process it will become necessary to cut track to fit. Be sure to take care in cutting the end of the track that does not join to another track. Manufactured ends of track are ideal for joining with connector. Cut ends may be capped off at the end of the track using the **End Cap** or the **End Wall Plate**.

Example:

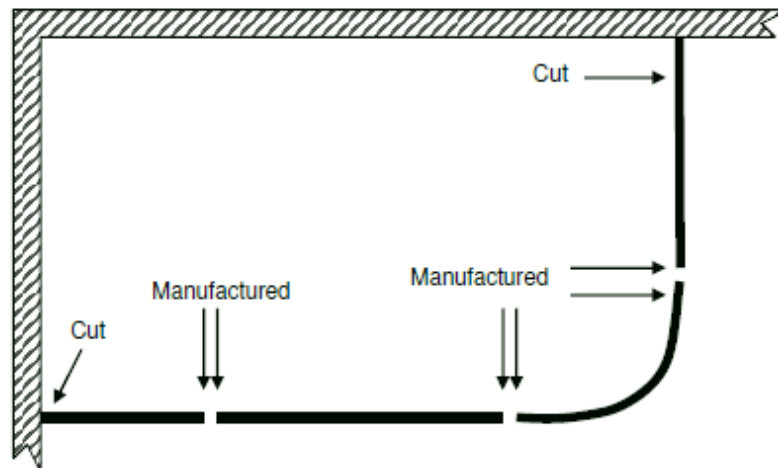



OTRT Track Specifications ALL INCLUSIVE

h. ASSEMBLY INSTRUCTIONS (Continued)

Installation Instructions

To connect **End Wall Plates*** and **End Caps**, simply slide into place and secure with **Self Tap Screw**.



***Special Note:** Securing the **End Wall Plate** with the **Self Tap Screw** will be the last step in the entire installation.

(This does not apply to the **End Cap**, feel free to secure with **Self Tap Screw** after determining proper length of track.)



PARTS ASSEMBLY

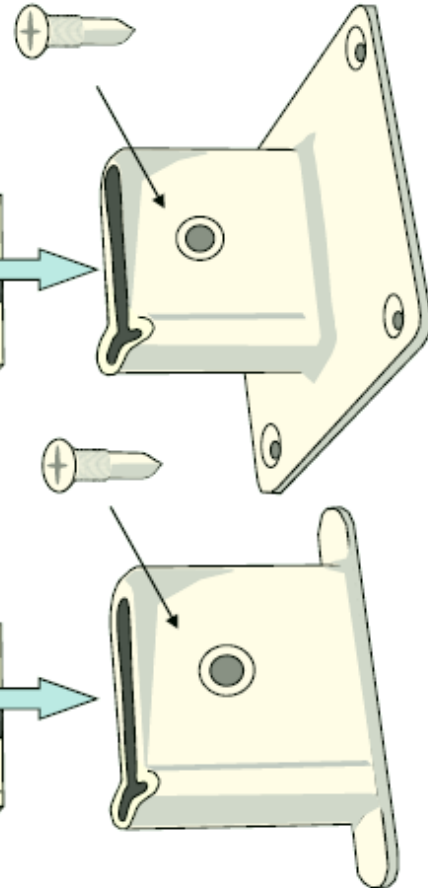

One of the final steps of installation involves placing the **Hanger & Track Connector**. Place the end of the **H&T Connector** into the groove on the back side of the Track and turn clockwise 1/4 turn. This will lock the **H&T Connector** into place. To reposition, simply reverse the process.

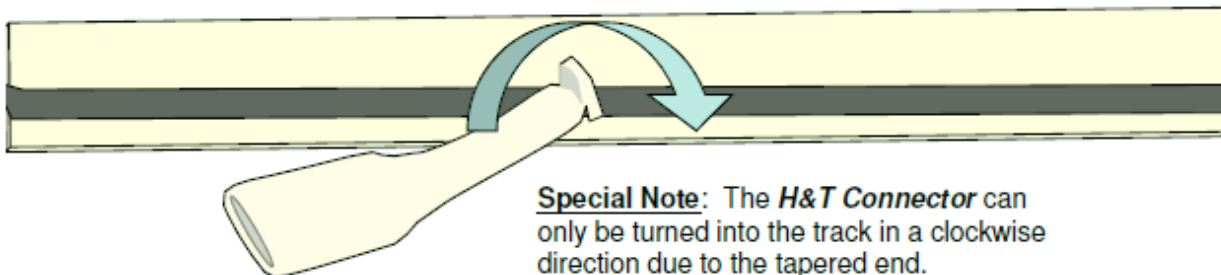

Special Note: The **H&T Connector** can only be turned into the track in a clockwise direction due to the tapered end.